

IU HEALTH NEW DOWNTOWN CAMPUS

SWC 16TH ST & CAPITOL AVE | DOWNTOWN INDIANAPOLIS



14K
Daily
Population



44
Acres



2.1M
Square
Feet

Seeking Restaurant Concepts for Two Food Halls

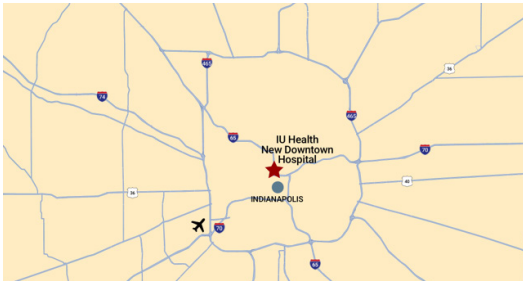

PROPERTY HIGHLIGHTS

- **Captive Audience:** We are transforming routine hospital dining into an inviting experience that offers a welcome and accessible culinary destination for patients, families, staff, and neighbors. With a projected daily population of 14,000+ people.
- **Prime Downtown Location:** Situated in the heart of a revitalized downtown Indianapolis, the campus stretches south to I-65, making it easily accessible for both on-campus individuals and the surrounding community.
- **Expansive Campus:** This monumental project spans 44 acres and features three towers comprising a total of 2.1 million square feet. This is a self-contained community poised for diverse dining experiences.
- **State-of-the-Art Facilities:** This new complex includes 864 beds, 50 operating rooms, 380 outpatient exam rooms, and 2 helipads.
- **Serve Every Palate and Pace:** Our aim is to cater to a wide audience, offering a wide range of dining options to meet every need and budget.
- **The Future of Hospital Dining:** Our vision is to set a new standard for healthcare dining, moving beyond traditional cafeterias to offer amenities that truly enhance the well-being of our community.



864
Hospital
Beds



50
Operating
Rooms



2
Helipads

EXCLUSIVE AGENTS

Cheryl Beckel 949/973-5587
cbeckel@khlretail.com

David Stone
Designated Managing Broker
dstone@stonerealestate.com 312/372-2657

IU HEALTH NEW DOWNTOWN CAMPUS

SWC 16TH ST & CAPITOL AVE | DOWNTOWN INDIANAPOLIS

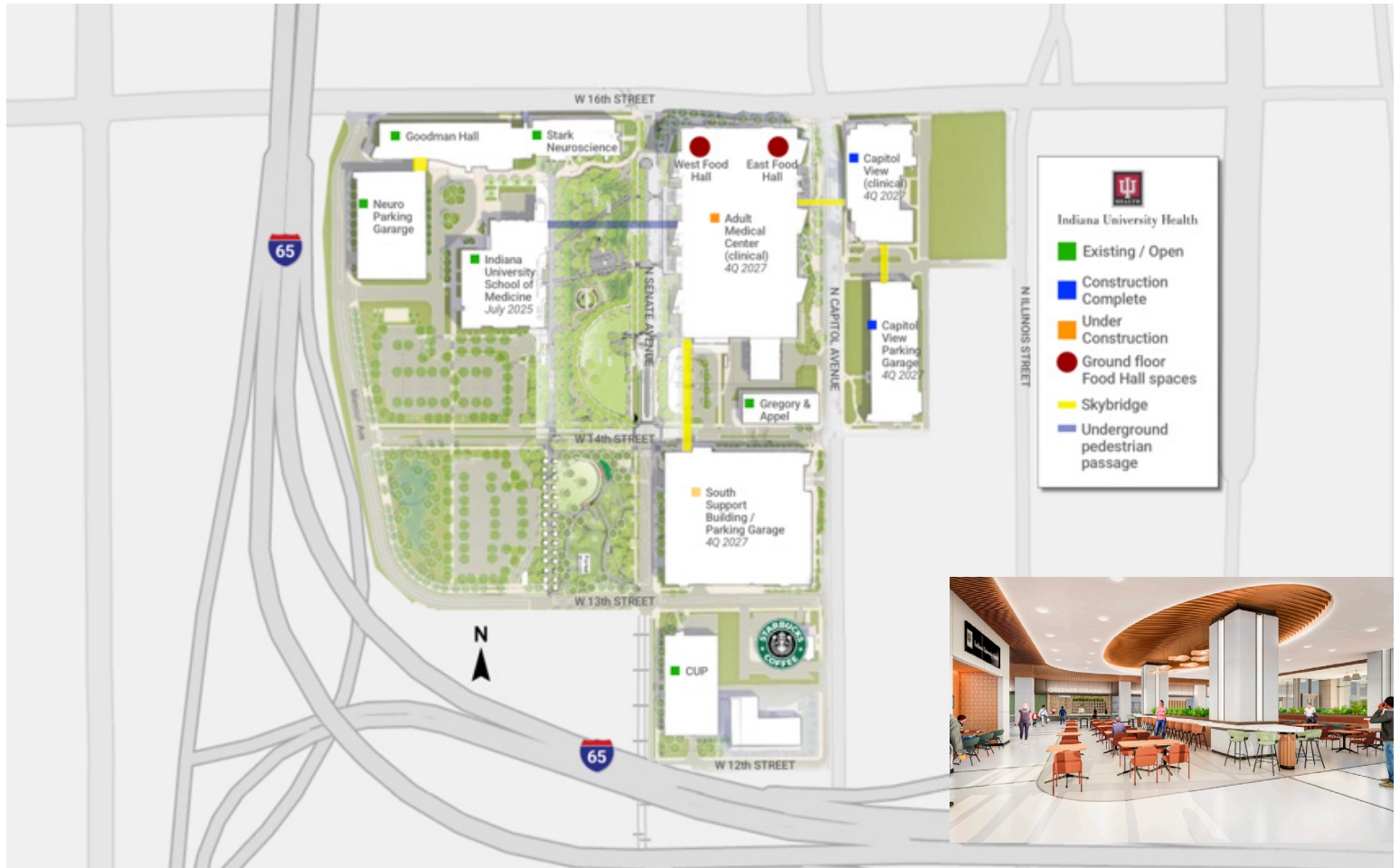

EXCLUSIVE AGENTS
Cheryl Beckel 949/973-5587
cbeckel@khlretail.com

David Stone
Designated Managing Broker
dstone@stonerealestate.com 312/372-2657

STONE
REAL ESTATE

IU HEALTH NEW DOWNTOWN CAMPUS

SWC 16TH ST & CAPITOL AVE | DOWNTOWN INDIANAPOLIS

EAST FOOD HALL LEASE PLAN

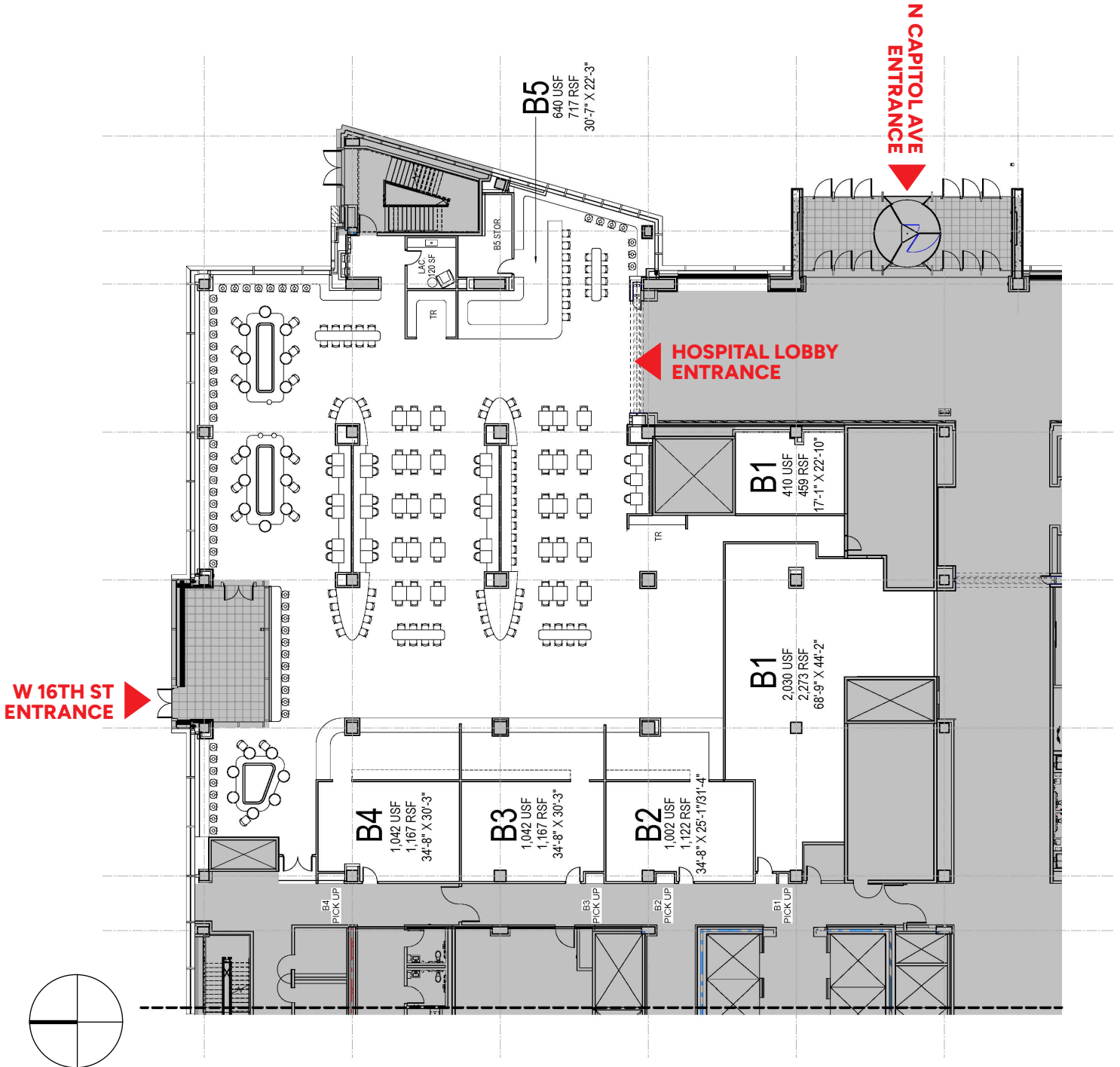

EXCLUSIVE AGENTS

Cheryl Beckel 949/973-5587
cbeckel@khlretail.com

David Stone
Designated Managing Broker
dstone@stonerealestate.com 312/372-2657

STONE
REAL ESTATE