

STONE REAL ESTATE

3514 NORTH SOUTHPORT



1,916

Square feet available



255K

Households in a three mile radius



\$209K

Household income in a one mile radius

Your Brand, Front and Center on Southport



PROPERTY DESCRIPTION

Ideally located along the best block of Chicago's quintessential boutique street, 3514 N. Southport presents retailers with an exceptional branding opportunity. Situated within A+ co-tenancy and close to Southport's "L" station, small shop space has finally become available. With such strong demographics surrounding the trade area, no wonder that the existing Southport retailers generate strong sales volumes.

AREA RETAILERS AND ATTRACTIONS

WARBY PARKER

ANTHROPOLOGIE

ATHLETA

BONOBOS

 lululemon

J. Crew

BUCK MASON

 jen's

 café

 ARCTERYX

CROSBY'S KITCHEN

free people

Casper

SEPHORA

 KENDRA SCOTT

 vuori

 benefit

LUSH

DEMOGRAPHICS

	1 MILE	2 MILE	3 MILE
POPULATION	82,163	272,397	503,604
AVG HH INCOME	\$209,902	\$178,344	\$171,858
DAYTIME POP	28,228	84,503	145,736



503K

Total population in a three mile radius



695K

2023 Southport Brown Line Station entries

EXCLUSIVE AGENTS

William Winter 312/878-9445
wwinter@stoncrealestate.com

Jason Gustaveson 312/372-2688
jason@stoncrealestate.com

STONE
REAL ESTATE

This information is from sources we deem to be reliable, however nothing contained herein should be construed as a representation on our part, as no independent verification of the information has been made by us.



STONE REAL ESTATE

3514 NORTH SOUTHPORT

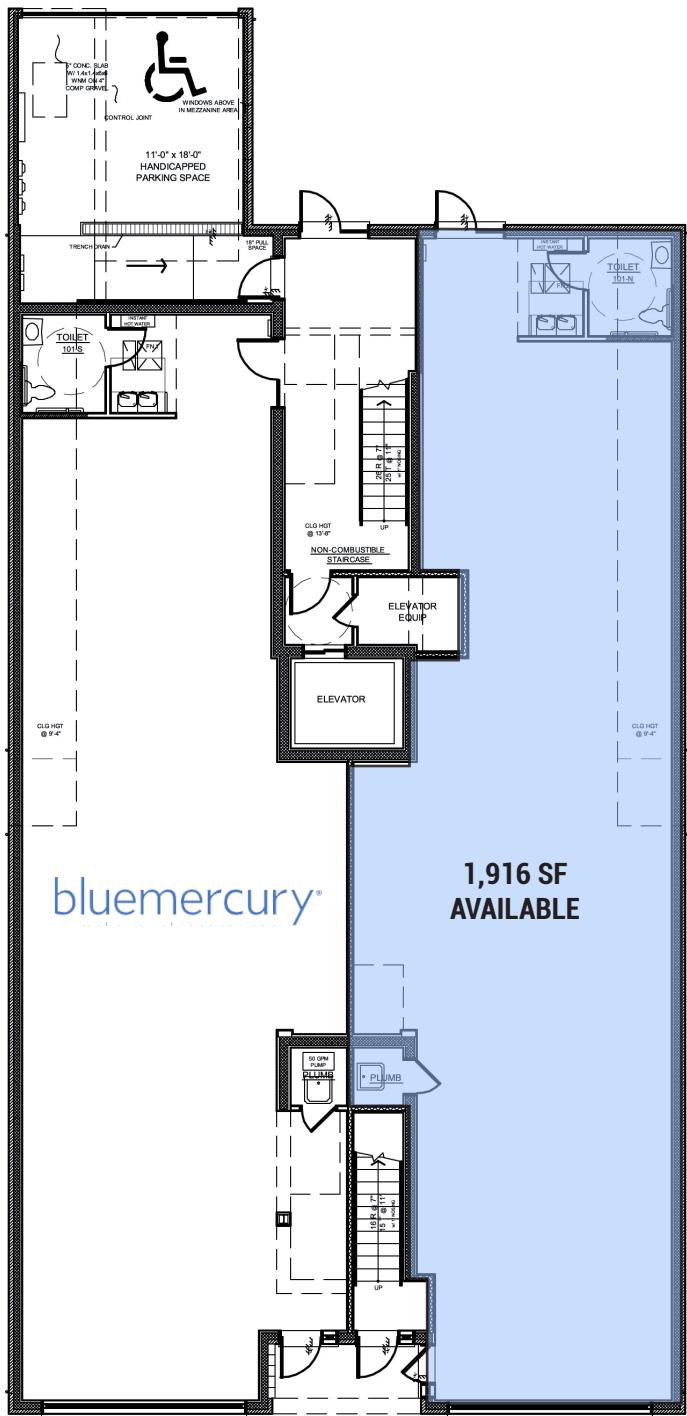

SOUTHPORT AVE

EXCLUSIVE AGENTS

William Winter 312/878-9445
wwinter@stonerealestate.com

Jason Gustaveson 312/372-2688
jason@stonerealestate.com

STONE
REAL ESTATE

STONE REAL ESTATE

3514 NORTH SOUTHPORT

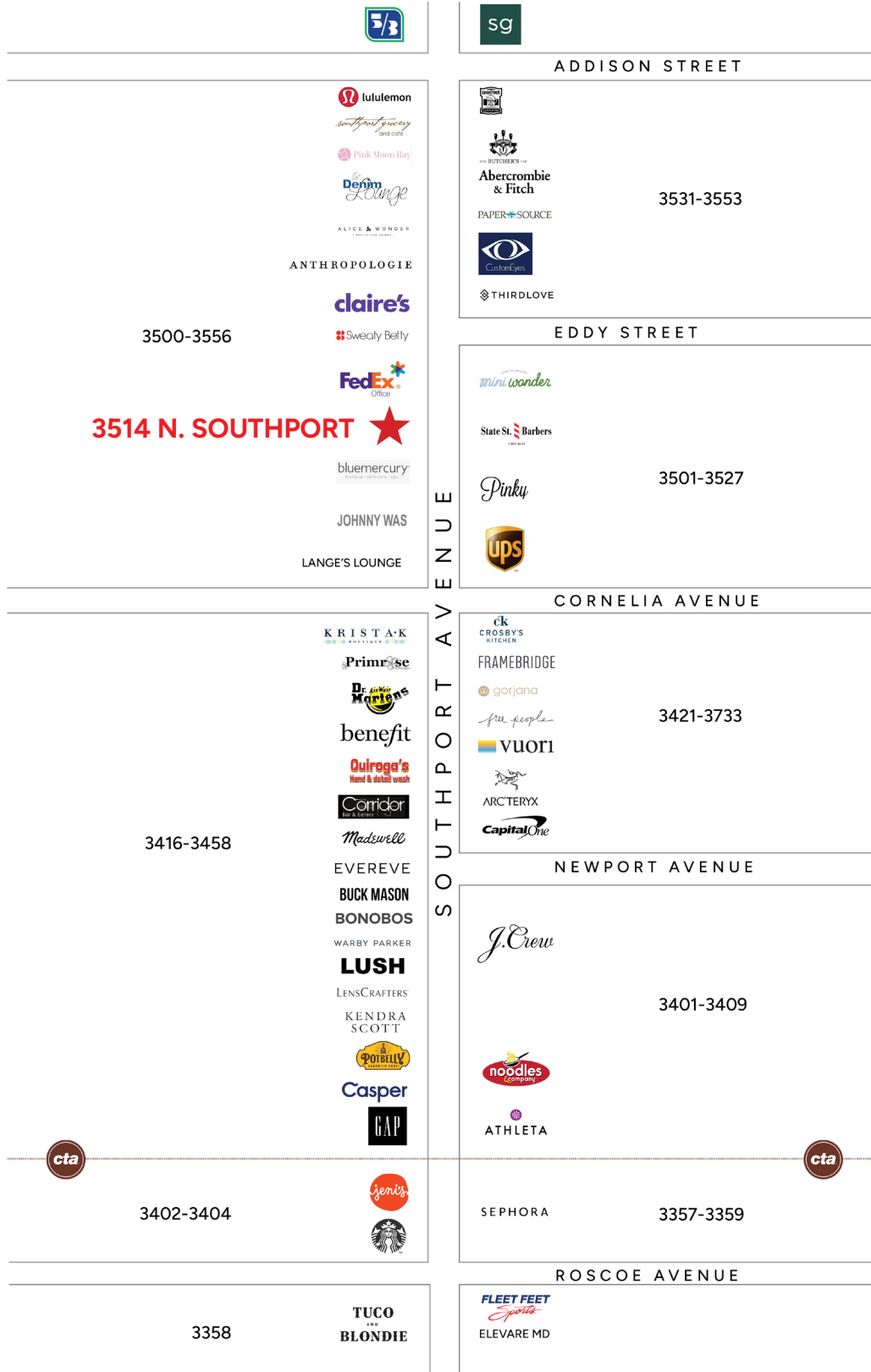

EXCLUSIVE AGENTS

William Winter 312/878-9445
wwinter@stonerealestate.com

Jason Gustaveson 312/372-2688
jason@stonerealestate.com

STONE
REAL ESTATE