

STONE REAL ESTATE

# 160 N. ELIZABETH | FULTON MARKET



## Fulton Market Corner - Enough Said



### PROPERTY DESCRIPTION

Sitting at the base of 375 luxury residential units, the retail at Fulbrix places retailers and restaurateurs at Fulton Market's doorstep. Fulton Market's dense mixture of residential, office and hospitality has created a true 24/7, 365-day trade area that is now Chicago's hottest neighborhood. The site's corner positioning and outsized frontage offers you the opportunity to join an unparalleled mix of soft goods retailers and food and beverage operators.

### AREA RETAILERS



### DEMOGRAPHICS

	.5 MILE	1 MILE	2 MILE
POPULATION	15,963	63,460	250,042
HOUSEHOLDS	9,346	35,320	138,411
AVERAGE HH INCOME	\$239,103	\$200,917	\$188,458
DAYTIME POPULATION	28,263	88,121	593,830



**8,996**

Square feet available



**205'**

Frontage on Randolph



**60'**

Frontage on Elizabeth



**375**

Luxury residential units



**250K**

Population in two mile radius



**\$239K**

Average HH income in a half mile radius

### EXCLUSIVE AGENTS

**John Vance** 312/782-1373  
jvance@stonerealestate.com

**William Winter** 312/878-9445  
wwinter@stonerealestate.com

**STONE**  
REAL ESTATE

This information is from sources we deem to be reliable, however nothing contained herein should be construed as a representation on our part, as no independent verification of the information has been made by us.



STONE REAL ESTATE

160 N. ELIZABETH | FULTON MARKET

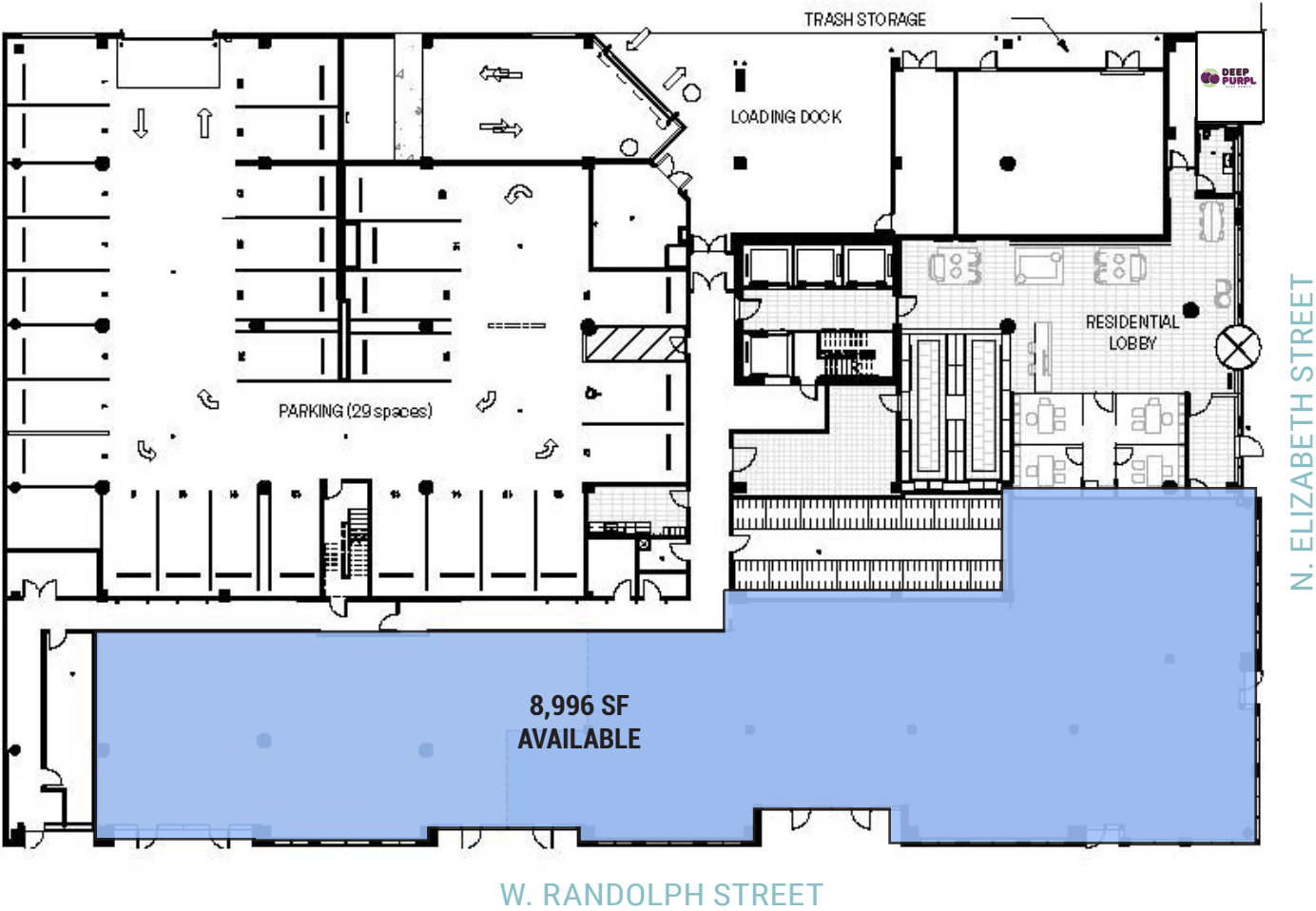

EXCLUSIVE AGENTS

**John Vance** 312/782-1373  
jvance@stonerealestate.com

**William Winter** 312/878-9445  
wwinter@stonerealestate.com

**STONE**  
REAL ESTATE