

PERSHING ROAD REDEVELOPMENT

1717 W. PERSHING | MCKINLEY PARK



2.2-34.4K

Square Feet Available



96K

Daytime Population in a Three Mile Radius



\$96K

Average HH Income in a Half Mile Radius



19.2K

Vehicles Per Day on West Pershing



339K

People in a Three Mile Radius

New Large Scale, Mixed Use, Urban Campus Development

PROPERTY DESCRIPTION

- +/- 4 Miles Southwest of Chicago's CBD
- Rare New Construction Urban Retail Opportunity
- Big Box, Drive Thru, and Small Shop Availabilities
- Convenient Surface Parking
- Infill High Barrier to Entry Market
- Campus Project Includes:
 - ± 172 "Affordable" / Work Forced Housing Units
 - ± 180,000 sf of Deep Tech / High Science Lab Space
 - Outdoor (Green) & Indoor Amenity Space
- Diverse Community W/ Over 330,000+ people (3 Mile)
- Avg HH Income of +/- \$96,000 (Half Mile)
- Estimated Delivery Date: First Quarter 2027

AREA CO-TENANTS



DEMOGRAPHICS

	1/2 MILE	1 MILE	3 MILE
POPULATION	5,346	23,340	339,162
HOUSEHOLDS	1,882	8,072	120,227
AVERAGE HH INCOME	\$96,378	\$88,631	\$80,854
DAYTIME POPULATION	1,614	15,617	96,739

EXCLUSIVE AGENTS

Noah O'Neill 312/245-5206
noah@stonerealestate.com

Ves Pavlovic 312/782-1374
ves@stonerealestate.com

STONE
REAL ESTATE

PERSHING ROAD REDEVELOPMENT

1717 W. PERSHING | MCKINLEY PARK

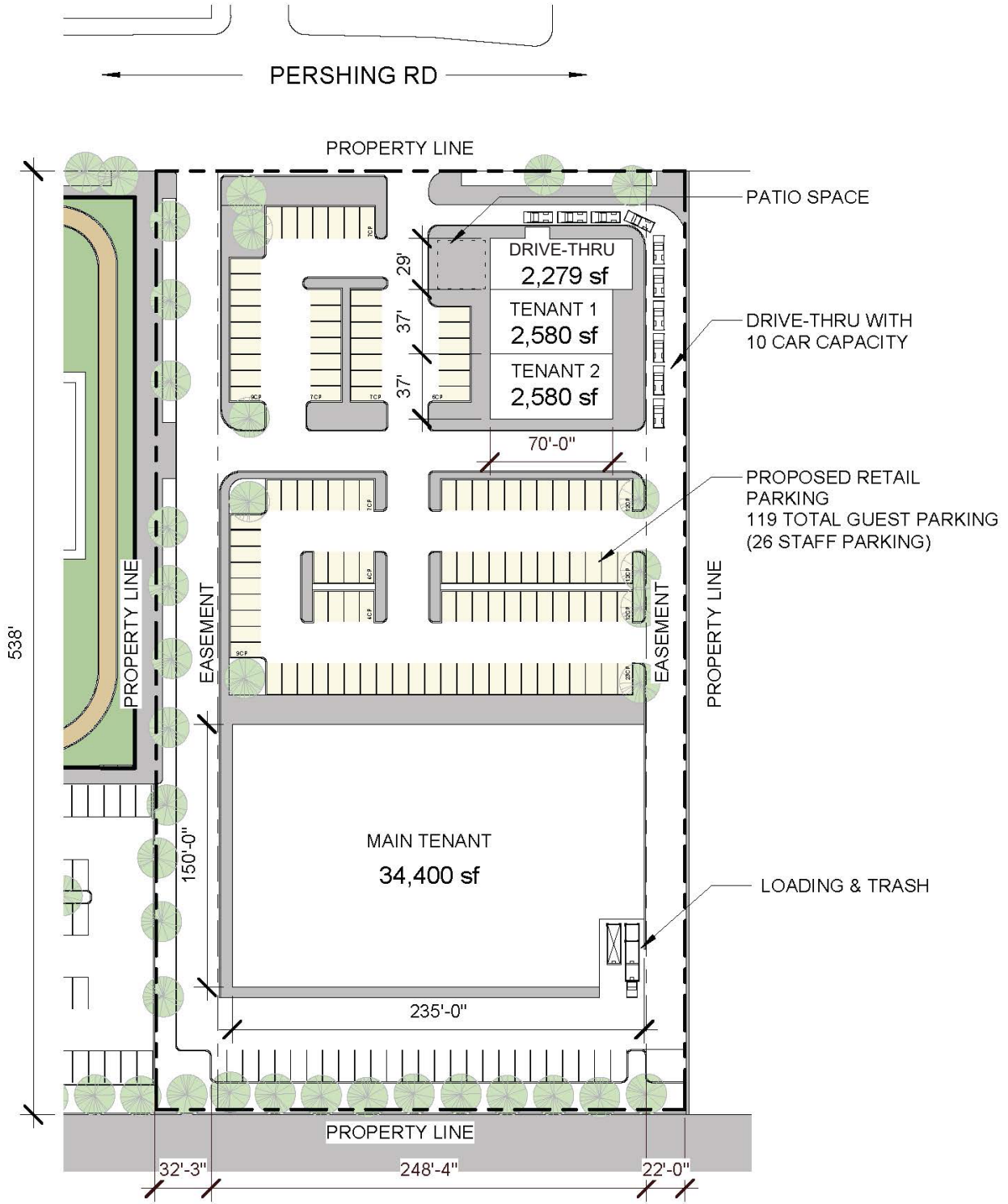

EXCLUSIVE AGENTS

Noah O'Neill 312/245-5206
noah@stonerealestate.com

Ves Pavlovic 312/782-1374
ves@stonerealestate.com

