

STONE REAL ESTATE

PARKLINE TOWER | 60 E. RANDOLPH



1.6K & 1.7K

Square feet available



60'

Frontage on Wabash



29'

Frontage on Randolph

Tourists, Residents and Office Workers; Parkline is Near Everything!



PROPERTY DESCRIPTION

Sitting at the northeast corner of Randolph & Wabash, Parkline Tower soars 26 stories high and contains 213 luxury residential units. Located just one block away from Millennium Park and located amidst the residential and office high rise buildings along Michigan and Wabash, the location offers access to one of the most diverse customer bases in Chicago. With prime availabilities fronting both Wabash and Randolph, Parkline presents retailers and restauranters the opportunity to showcase their brand in a distinct Chicago neighborhood, the East Loop.



104K

Population in one mile radius



18.8K

Vehicles per day at the intersection



\$234K

Average HH income in a half mile radius

AREA RETAILERS AND ATTRACTIONS



EXCLUSIVE AGENTS

John Vance 312/782-1373
jvance@stonerealestate.com

William Winter 312/878-9445
wwinter@stonerealestate.com

STONE
REAL ESTATE

This information is from sources we deem to be reliable, however nothing contained herein should be construed as a representation on our part, as no independent verification of the information has been made by us.



STONE REAL ESTATE

PARKLINE TOWER | 60 E. RANDOLPH



EXCLUSIVE AGENTS

John Vance 312/782-1373
jvance@stonerealestate.com

William Winter 312/878-9445
wwinter@stonerealestate.com

STONE
REAL ESTATE

PARKLINE TOWER | 60 E. RANDOLPH

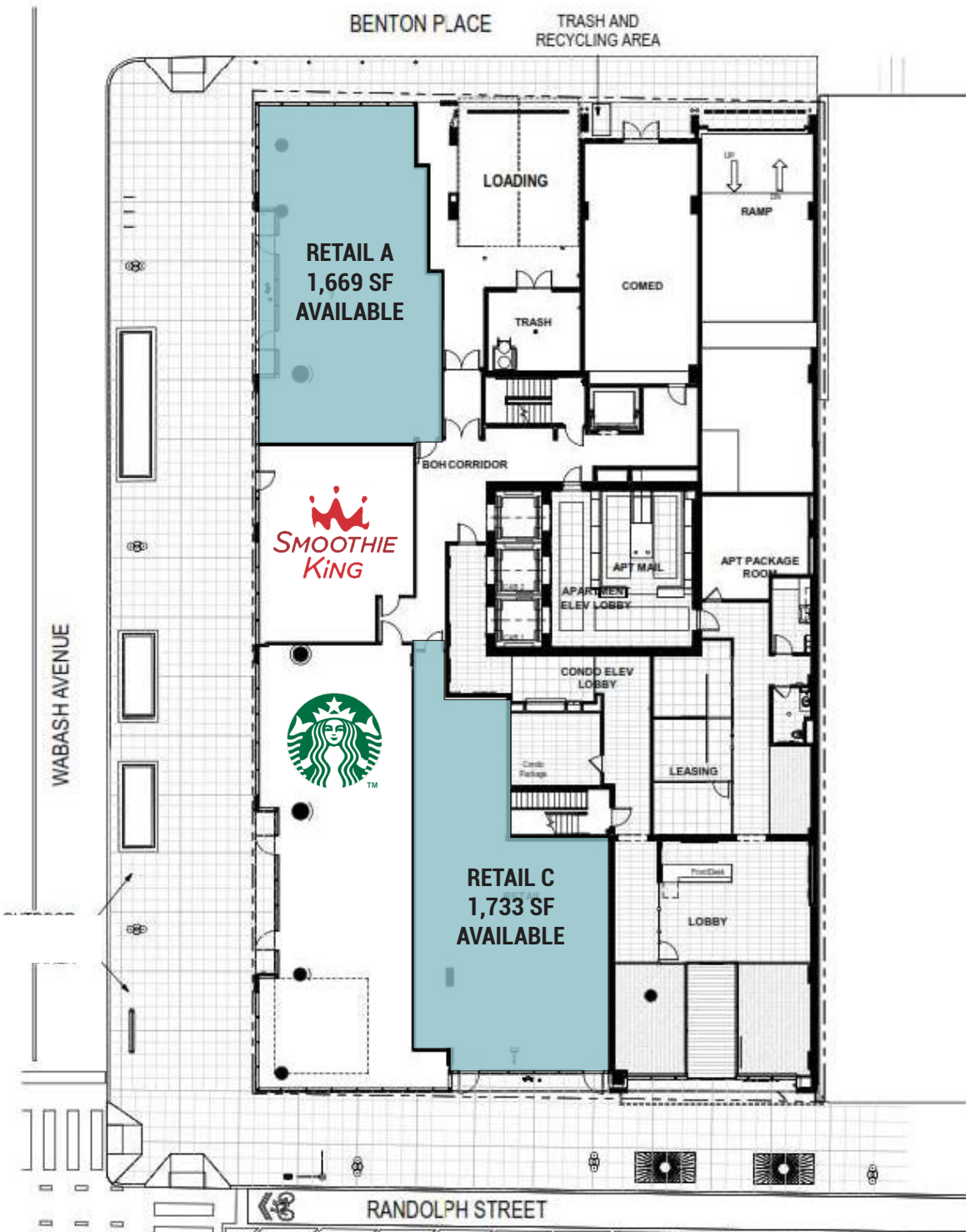

EXCLUSIVE AGENTS

John Vance 312/782-1373
jvance@stonerealestate.com

William Winter 312/878-9445
wwinter@stonerealestate.com