

STONE REAL ESTATE

# PARKLINE TOWER | 60 E. RANDOLPH



**1,628**

Square feet available



**60'**

Frontage on Wabash

**Tourists, Residents and Office Workers; Parkline is Near Everything!**



**104K**

Population in one mile radius



**18.8K**

Vehicles per day at the intersection



**\$234K**

Average HH income in a half mile radius



## PROPERTY DESCRIPTION

Sitting at the northeast corner of Randolph & Wabash, Parkline Tower soars 26 stories high and contains 213 luxury residential units. Located just one block away from Millennium Park and located amidst the residential and office high rise buildings along Michigan and Wabash, the location offers access to one of the most diverse customer bases in Chicago. Only one availability remains fronting Wabash for an opportunity to showcase your brand in a distinct Chicago neighborhood, the East Loop.

## AREA RETAILERS AND ATTRACTIONS



## EXCLUSIVE AGENTS

**John Vance** 312/782-1373  
jvance@stonerealestate.com

**William Winter** 312/878-9445  
wwinter@stonerealestate.com

**STONE**  
REAL ESTATE

This information is from sources we deem to be reliable, however nothing contained herein should be construed as a representation on our part, as no independent verification of the information has been made by us.





STONE REAL ESTATE

# PARKLINE TOWER | 60 E. RANDOLPH

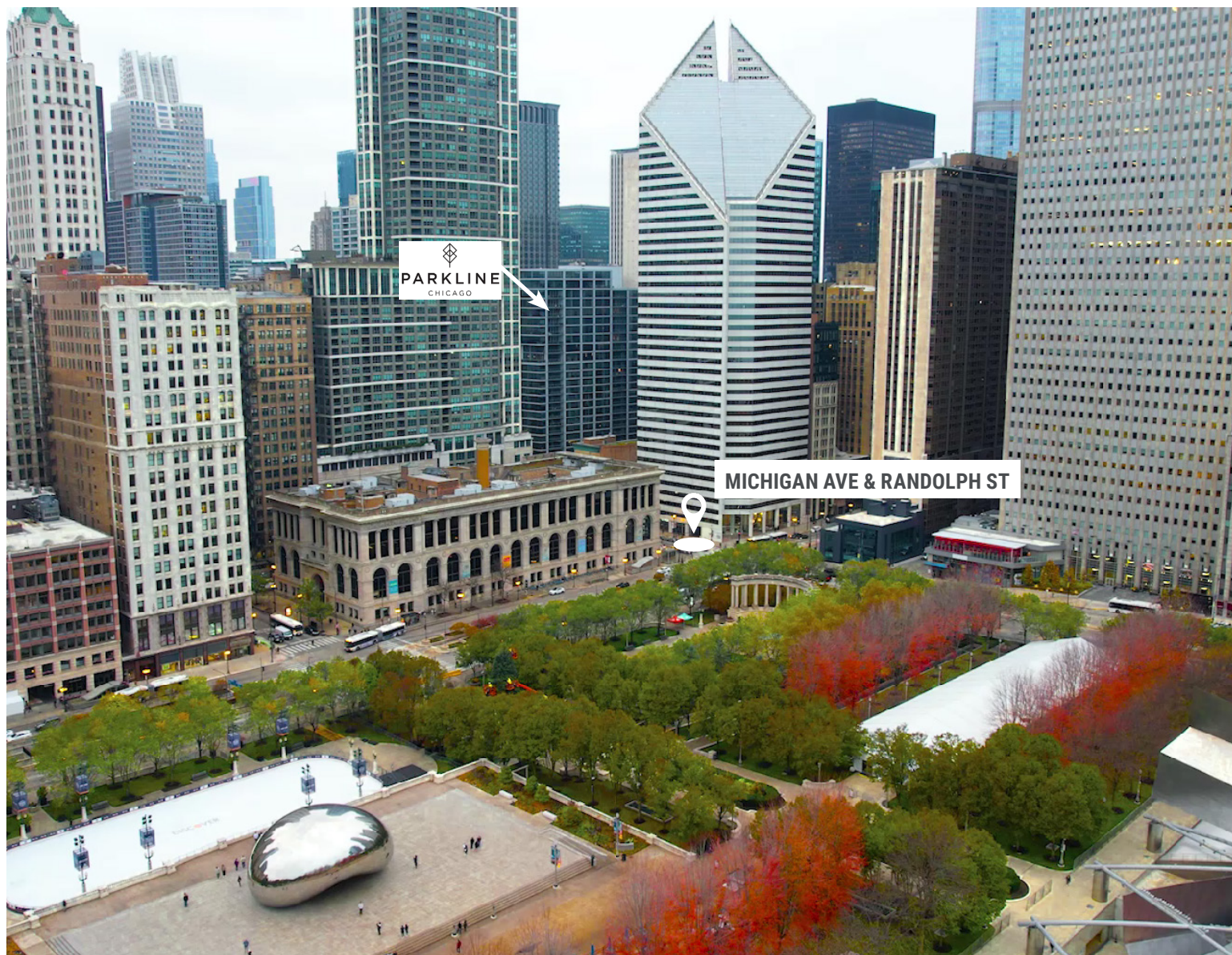

EXCLUSIVE AGENTS

**John Vance** 312/782-1373  
jvance@stonerealestate.com

**William Winter** 312/878-9445  
wwinter@stonerealestate.com

**STONE**  
REAL ESTATE

PARKLINE TOWER | 60 E. RANDOLPH

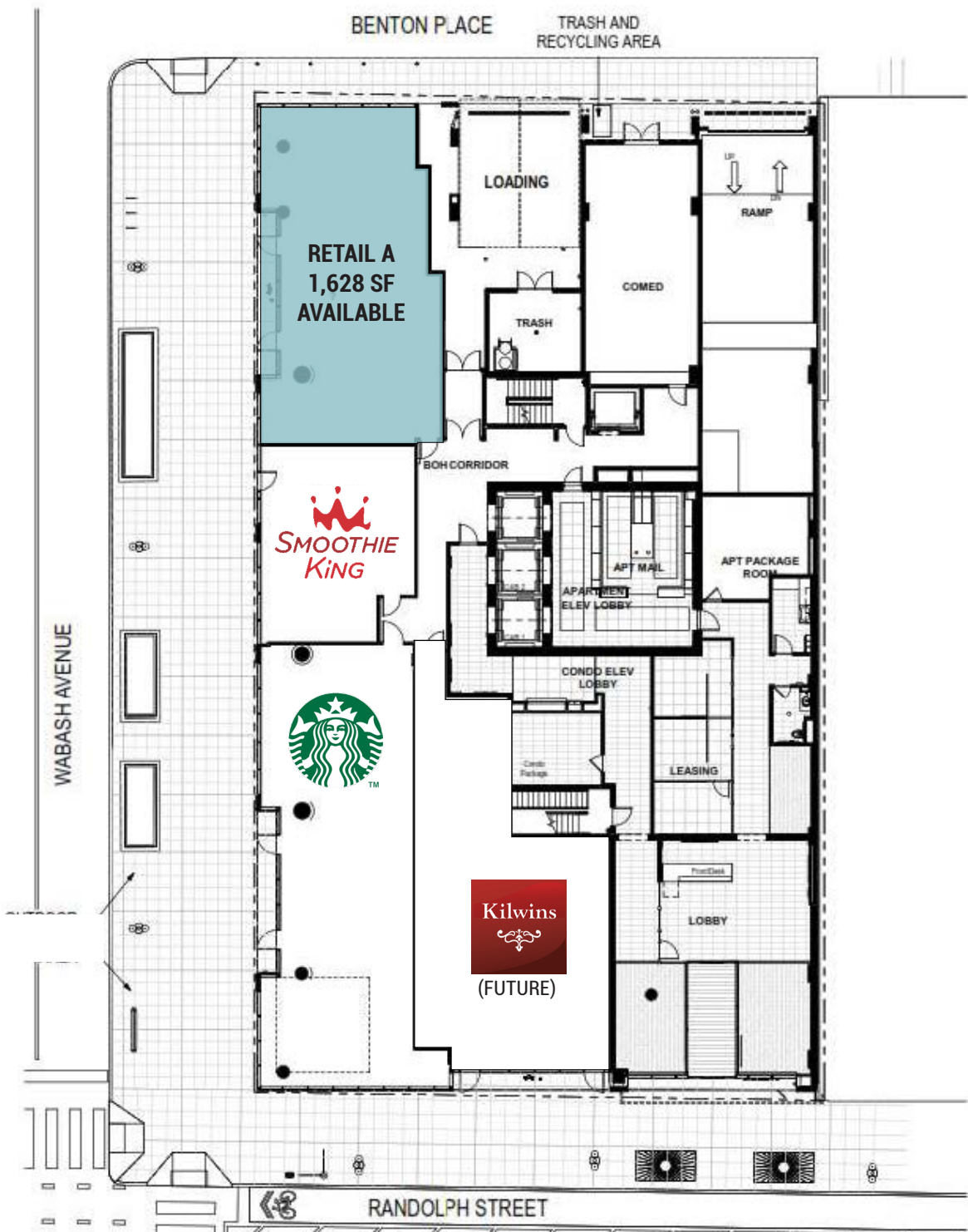

EXCLUSIVE AGENTS

**John Vance** 312/782-1373  
jvance@stonerealestate.com

**William Winter** 312/878-9445  
wwinter@stonerealestate.com

**STONE**  
REAL ESTATE