

STONE REAL ESTATE

PARKLINE TOWER | 60 E. RANDOLPH



1,628

Square feet available



60'

Frontage on Wabash

Tourists, Residents and Office Workers; Parkline is Near Everything!



104K

Population in one mile radius



18.8K

Vehicles per day at the intersection



\$234K

Average HH income in a half mile radius



PROPERTY DESCRIPTION

Sitting at the northeast corner of Randolph & Wabash, Parkline Tower soars 26 stories high and contains 213 luxury residential units. Located just one block away from Millennium Park and located amidst the residential and office high rise buildings along Michigan and Wabash, the location offers access to one of the most diverse customer bases in Chicago. Only one availability remains fronting Wabash for an opportunity to showcase your brand in a distinct Chicago neighborhood, the East Loop.

AREA RETAILERS AND ATTRACTIONS



EXCLUSIVE AGENTS

John Vance 312/782-1373
jvance@stonerealestate.com

William Winter 312/878-9445
wwinter@stonerealestate.com

STONE
REAL ESTATE

This information is from sources we deem to be reliable, however nothing contained herein should be construed as a representation on our part, as no independent verification of the information has been made by us.



STONE REAL ESTATE

PARKLINE TOWER | 60 E. RANDOLPH

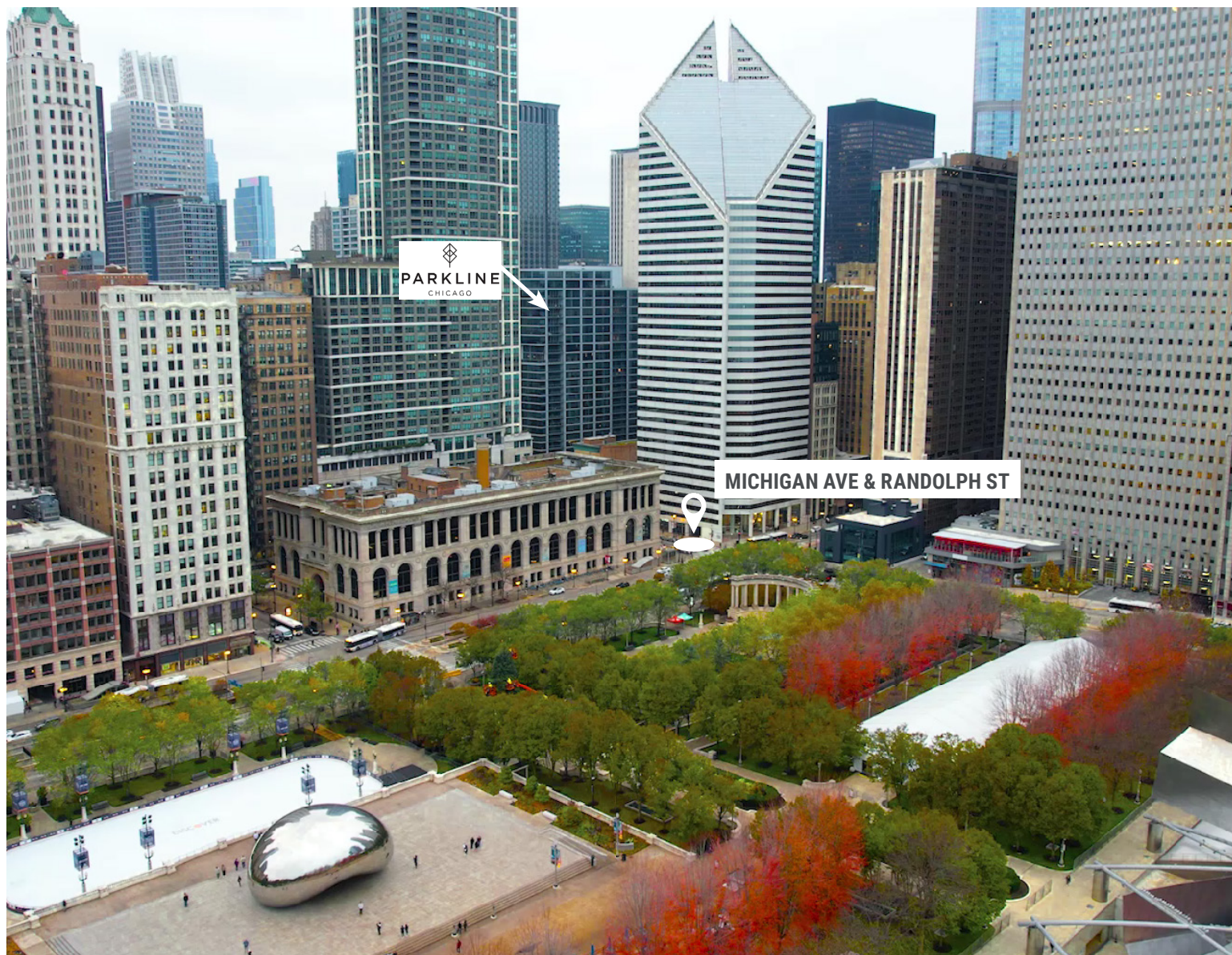

EXCLUSIVE AGENTS

John Vance 312/782-1373
jvance@stonerealestate.com

William Winter 312/878-9445
wwinter@stonerealestate.com

STONE
REAL ESTATE

PARKLINE TOWER | 60 E. RANDOLPH

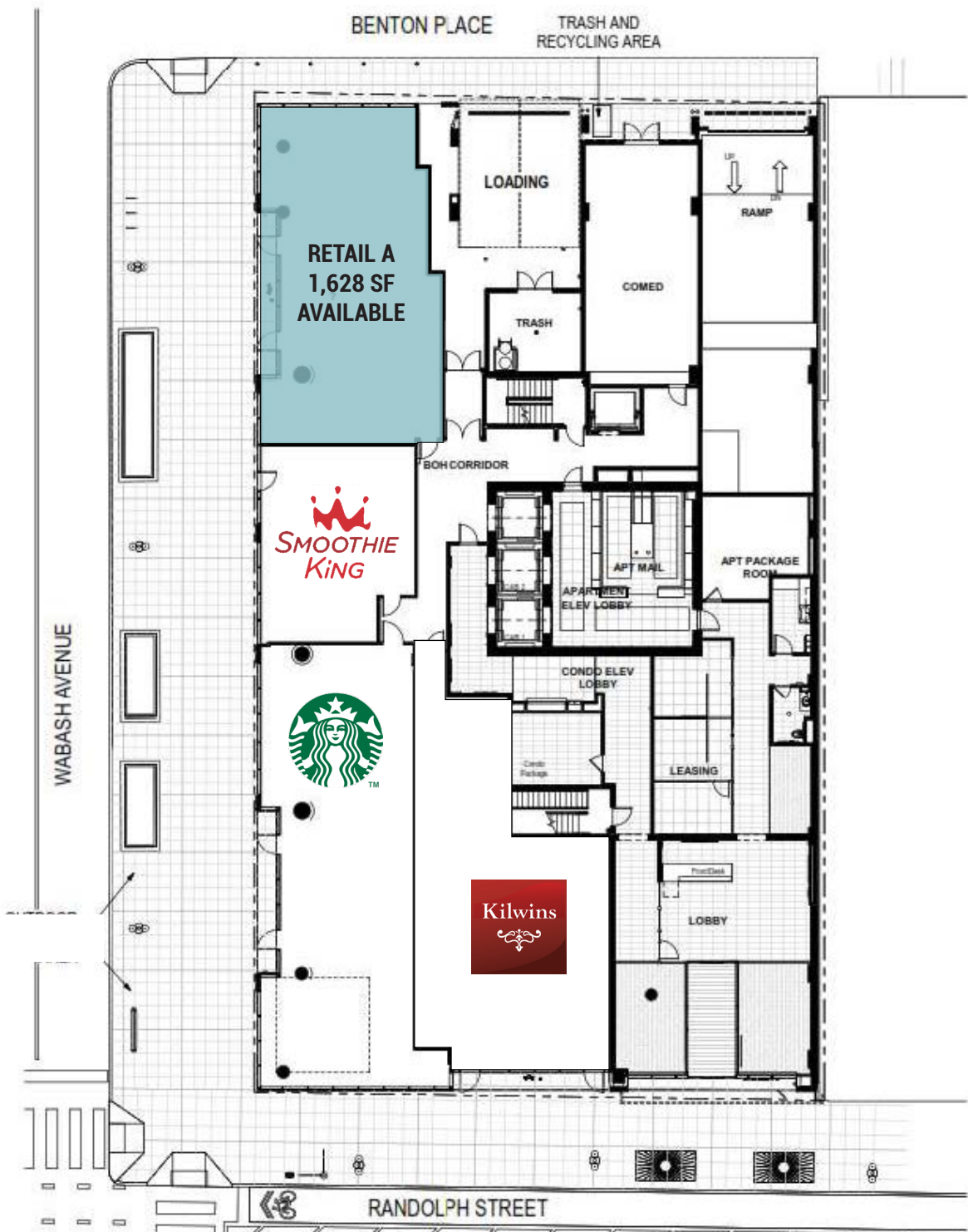

EXCLUSIVE AGENTS

John Vance 312/782-1373
jvance@stonerealestate.com

William Winter 312/878-9445
wwinter@stonerealestate.com

STONE
REAL ESTATE