

# 1520 N. MILWAUKEE AVE. | WICKER PARK



**3,062**  
Square Feet Available



**\$190K**  
Average HH Income in a One Mile Radius



## Premier Retail Space Available

### PROPERTY DESCRIPTION

- Highly visible space in the heart of Wicker Park surrounded by a unique mix of national and local retailers;
- Unique single story historic building with prominent signage;
- Move in ready space ideal for apparel retailer;
- Located walking distance from the Damen CTA stop which has over 2 million annual riders;
- Surrounded by Wicker Park's dense and growing residential population and steps away from one of Chicago's busiest intersections of North Ave., Damen Ave. and Milwaukee Ave.



**219K**  
People in a Two Mile Radius



**104K**  
Households in a Two Mile Radius

### DEMOGRAPHICS

	.5 MILE	1 MILE	2 MILE
POPULATION	18,897	64,189	219,609
HOUSEHOLDS	9,507	31,836	104,683
AVERAGE HH INCOME	\$231,821	\$190,703	\$189,980
DAYTIME POPULATION	7,257	23,956	106,699

### AREA CO-TENANTS



**9,850**  
Vehicles Per Day on Milwaukee Ave.

#### EXCLUSIVE AGENTS

**Ves Pavlovic** 312/782-1374  
ves@stonerealestate.com

**Noah O'Neill** 312/245-5206  
noah@stonerealestate.com

**STONE**  
REAL ESTATE

STONE REAL ESTATE

# 1520 N. MILWAUKEE AVE. | WICKER PARK

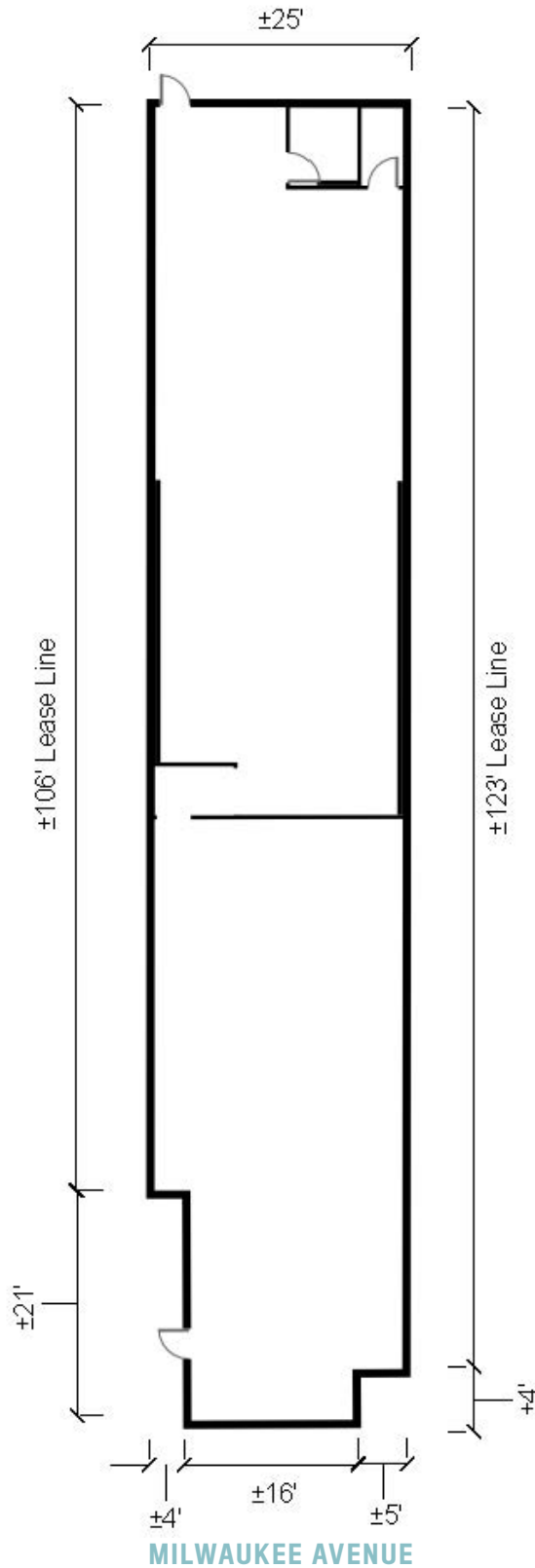

EXCLUSIVE AGENTS

**Ves Pavlovic** 312/782-1374  
ves@stonerealestate.com

**Noah O'Neill** 312/245-5206  
noah@stonerealestate.com

**STONE**  
REAL ESTATE

# 1520 N. MILWAUKEE AVE. | WICKER PARK

## NORTH AVENUE

- 1576 N. Milwaukee •
- 1572 N. Milwaukee • **YETI**
- 1566 N. Milwaukee • **The Revel Room**
- 1564 N. Milwaukee • **MYOPIC**
- 1562 N. Milwaukee • **Bru**
- 1560 N. Milwaukee • **Kama Indian Food**
- 1558 N. Milwaukee • **TAXIM**
- 1554 N. Milwaukee •
- 1552 N. Milwaukee • **Levi's**
- 1550 N. Milwaukee • **LUBINSKI**  
Furniture & Movers
- 1540 N. Milwaukee • **DSTRKT**  
CHICAGO
- 1538 N. Milwaukee • **MOVEMENT**  
*for people*
- 1534 N. Milwaukee • **rumi**  
MIDWESTERN CUISINE  
*and more*
- 1532 N. Milwaukee • **adidas**
- 1528 N. Milwaukee • **uNa Mae'S**
- 1524 N. Milwaukee • **thecodexchange**
- 1520 N. Milwaukee • 
- 1518 N. Milwaukee • **carhartt.**
- 1516 N. Milwaukee • **Nick's Beergarden**
- 1514 N. Milwaukee • **2nd STREET**

## HONORE STREET

- 1484 N. Milwaukee • **CAVA**
- 1480 N. Milwaukee • **明月**
- 1480 N. Milwaukee •
- 1478 N. Milwaukee • **BRUNO**
- 1476 N. Milwaukee • **BODYBAR**
- 1472 N. Milwaukee • **store B**
- 1470 N. Milwaukee • **bongo | room**
- 1468 N. Milwaukee • **MojoSpa**
- 1464 N. Milwaukee • **Free People**
- 1462 N. Milwaukee • **The Wormhole Coffee**
- 1460 N. Milwaukee •
- 1456 N. Milwaukee • **Metamorph studios**
- 1452 N. Milwaukee • **TRAINING**  
REVOLUTION  
BY TIGARD GYM
- 1448 N. Milwaukee • **Pleasure Chest**
- 1446 N. Milwaukee • **VACANT LOT**
- 1444 N. Milwaukee •
- 1442 N. Milwaukee • **TRCMBI**
- 1440 N. Milwaukee •
- 1438 N. Milwaukee • **Supreme**

## EVERGREEN AVENUE

MILWAUKEE AVENUE

- WELLS FARGO** • 1585 N. Milwaukee
- 1575 N. Milwaukee
- CHP CITY** • 1573 N. Milwaukee
- Seoul Stick** • 1571 N. Milwaukee
- 1565 N. Milwaukee
- BURTON** • 1563 N. Milwaukee
- Dr. Marten's** • 1561 N. Milwaukee
- Bloom Plant Based Kitchen** • 1559 N. Milwaukee
- Wanna Socks** • 1557 N. Milwaukee
-  • 1553 N. Milwaukee
- JOHN FLEUNOG** • 1551 N. Milwaukee
- Lone Owl** • 1547 N. Milwaukee
- Lids** • 1543 N. Milwaukee
- 1539 N. Milwaukee
-  • 1537 N. Milwaukee
- Pure Green** • 1533 N. Milwaukee
- Eiffel Waffle** • 1531 N. Milwaukee
- St. Alfred** • 1529 N. Milwaukee
- 1525 N. Milwaukee
- URBAN OUTFITTERS** • 1521 N. Milwaukee
- CROSSROADS TRADING CO.** • 1519 N. Milwaukee
- Urban Eyecare** • 1515 N. Milwaukee
- crumbl cookies** • 1513 N. Milwaukee
- Goldblatt Sewing Machine Inc** • 1511 N. Milwaukee
- Tropical Smoothie Cafe** • 1509 N. Milwaukee
- Vintage Underground** • 1507 N. Milwaukee
-  • 1505 N. Milwaukee
- 1501 N. Milwaukee

## HONORE STREET

- swaetgreen** • 1471 N. Milwaukee
- SWIG** • 1469 N. Milwaukee
- EN HAKKORE 2.0** • 1467 N. Milwaukee
- topdrawer** • 1463 N. Milwaukee
- RAGSTOCK** • 1459 N. Milwaukee
- BARRY'S** • 1455 N. Milwaukee
- Artemios Bakery** • 1443 N. Milwaukee
- Cash America** • 1441 N. Milwaukee
-  • 1439 N. Milwaukee
- frigo** • 1437 N. Milwaukee



EXCLUSIVE AGENTS

**Ves Pavlovic** 312/782-1374  
ves@stonerealestate.com

**Noah O'Neill** 312/245-5206  
noah@stonerealestate.com