

STONE REAL ESTATE

# RUSH UNIVERSITY MEDICAL CENTER NEC ASHLAND & HARRISON



**900**

Square feet available



**405K**

Daytime population in a two-mile radius



**30K**

Employees work in The Illinois Medical District

## Seeking Fast Casual Restaurant in Illinois Medical District

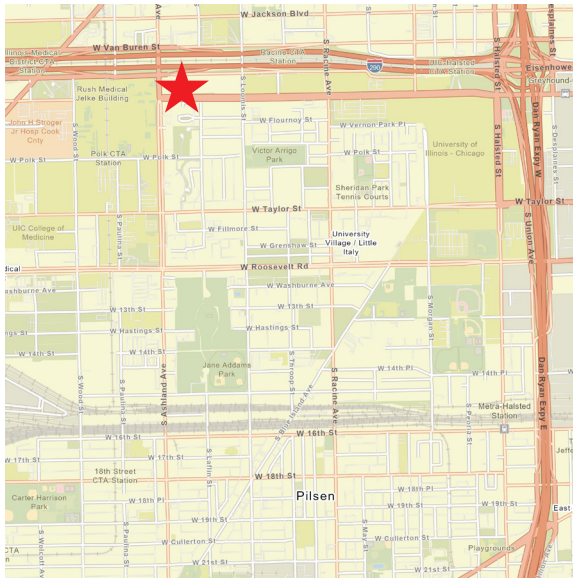

### AREA DESCRIPTION

- Located in the Rush University Medical Center's new Rubschlager Building, a 480,000 sf cancer treatment center with a 6-story, 900 space parking structure. Building functions to include Neurological care, imaging, and conference center.
- Part of the Illinois Medical District (IMD), the largest urban medical district in the country which includes four world-class hospitals (Rush University Medical Center, The University of Illinois Hospital, John H. Stroger, Jr. Hospital, and Jesse Brown VA Medical Center) and University of Illinois of Medicine (the largest medical school in the country).
- The Illinois Medical District is home to over 9,000 health sciences students, 2,200 hospital beds, 30,000 employees, 75,000 daily visitors, is adjacent to the Chicago Technology Park and across I-290 from the expanding Malcolm X College.
- A short walk from the Blue and Pink Line L stops, a half block from I-290 and one half mile from the United Center.

### AVAILABLE SPACES

- Ground Floor: 900 sf (Available); 1,150 sf (In Lease)
- Fourth Floor: 1,573 sf (In Lease)

### AREA RETAILERS



**\$127K**

Avg HH income in a two-mile radius



**177K**

Total population in a two-mile radius

	1/2 MILE	1 MILE	2 MILE
POPULATION	8,261	34,205	177,885
AVERAGE HH INCOME	\$101,418	\$117,267	\$127,049
DAYTIME POPULATION	32,836	76,317	405,512



**2M+**

Riders at the Blue & Pink Line stops

EXCLUSIVE AGENT

**David Stone**

Designated Managing Broker

dstone@stonerealestate.com 312/372-2657

**STONE**  
REAL ESTATE

# RUSH UNIVERSITY MEDICAL CENTER NEC ASHLAND & HARRISON



## RUBSCHLAGER GROUND FLOOR

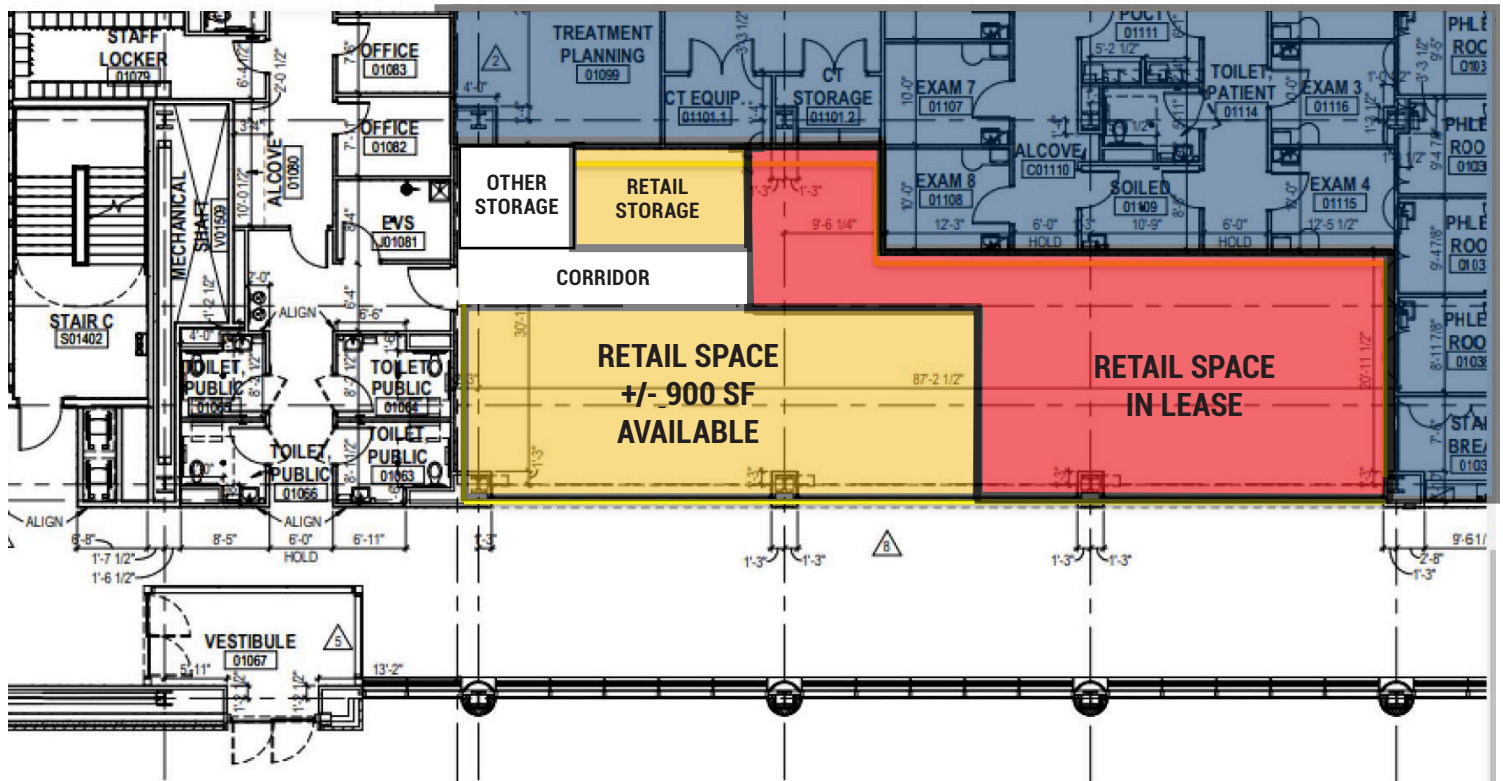

# RUSH UNIVERSITY MEDICAL CENTER NEC ASHLAND & HARRISON



STONE  
REAL ESTATE



STONE REAL ESTATE

# RUSH UNIVERSITY MEDICAL CENTER NEC ASHLAND & HARRISON

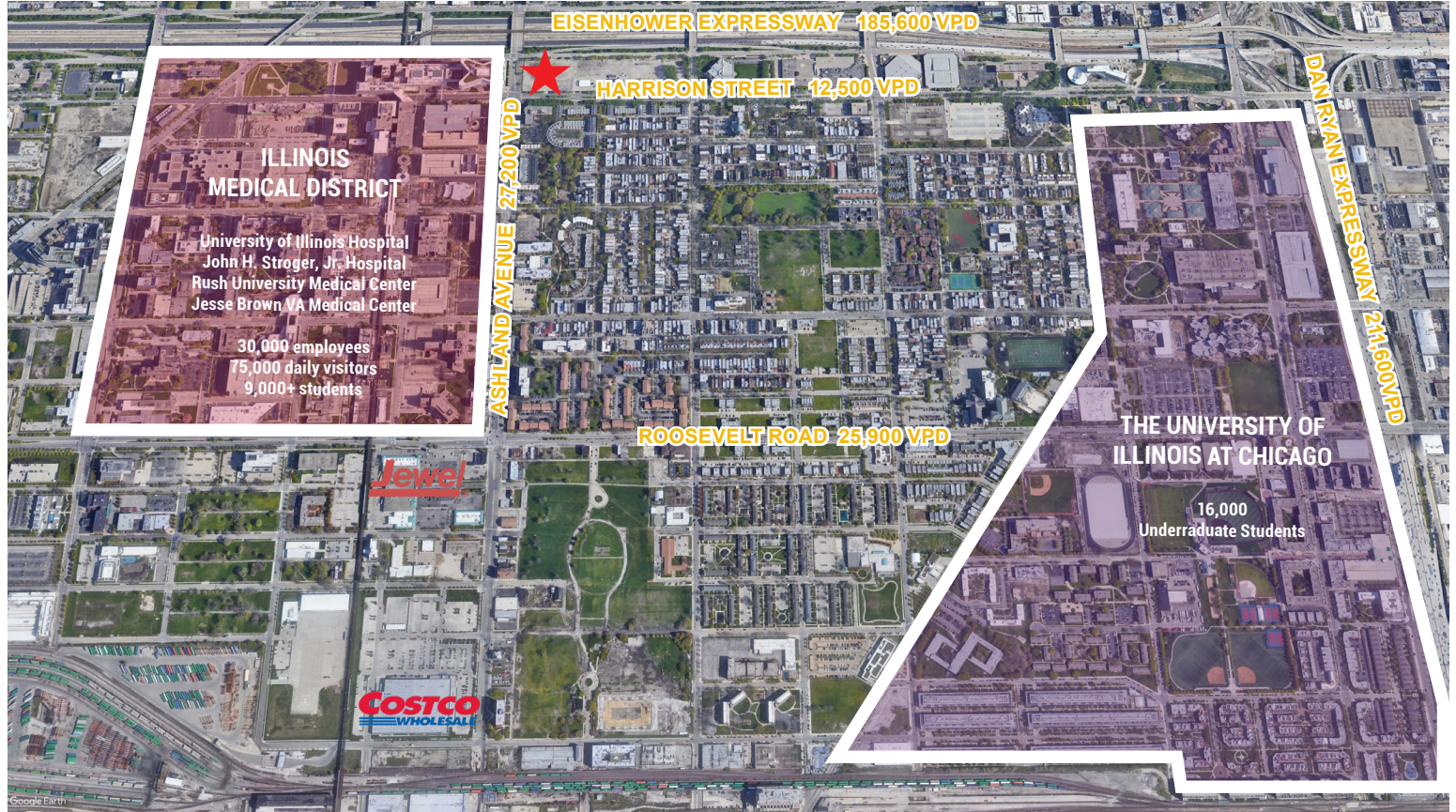

EXCLUSIVE AGENT

**David Stone**

Designated Managing Broker

[dstone@stonerealestate.com](mailto:dstone@stonerealestate.com) 312/372-2657

**STONE**  
REAL ESTATE