

STONE REAL ESTATE

137 S. STATE



9,000
Square feet
available



76'
Frontage on
State Street



15K
Population in
half-mile radius

Seize the Corner & Make a STATEment at 137 S. State

PROPERTY

Situated at the NEC of State & Adams, 137 S. State offers a rare corner location on Chicago's historic State Street. Centrally located within Chicago's Loop, the site provides close proximity to all the downtown subway lines, numerous buses and tremendous density from the office, student and residential population. The corner presence with 76' of State Street frontage, incredible pedestrian traffic and A+ co-tenancy presents retailers the opportunity to generate high volumes on Chicago's famed State Street.

AREA RETAILERS



165K
Daytime pop in
half-mile radius

AREA HOTELS & ATTRACTIONS



AREA UNIVERSITIES



\$154K
Avg HH income in a
half-mile radius



14.4K
Vehicles per day on
State Street

EXCLUSIVE AGENTS

John Vance 312/782-1373
jvance@stonerealestate.com

William Winter 312/878-9445
wwinter@stonerealestate.com

STONE
REAL ESTATE

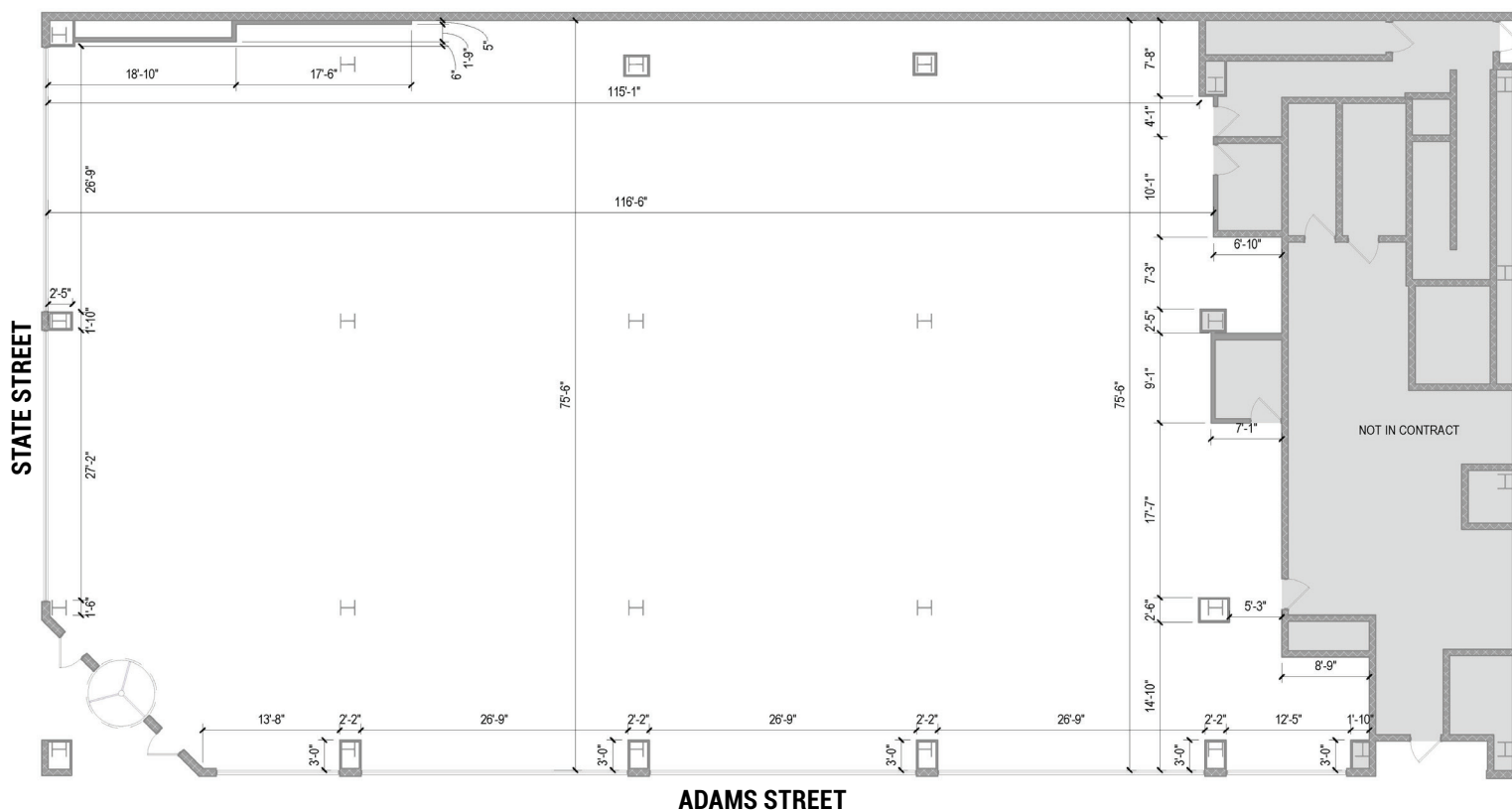

STONE
REAL ESTATE

STONE REAL ESTATE
137 S. STATE



EXCLUSIVE AGENTS
John Vance 312/782-1373
jvance@stonerealestate.com

William Winter 312/878-9445
wwinter@stonerealestate.com

STONE
REAL ESTATE